

UMK type Capacitor Switching Contactor

Rating and Characteristic

Electrical Lifetime		240 Cycles/h
AC-6b	$U_e \leq 440V_{ac}$	250,000 Operating Cycles
	$500V_{ac} \leq U_e \leq 690V_{ac}$	100,000 Operating Cycles

Model	Max.Power (kVAR) (50/60Hz) Ambient Temperature :55°C						Composition
	220V	230/240V	400/415V	440V	500/550V	690V	
UMK9	5	5	9.7	9.7	14	14	UMC9 + UAD100
UMK12	6.7	6.7	12.5	12.5	18	18	UMC12 + UAD100
UMK18	8.5	8.5	16.7	16.7	24	24	UMC18 + UAD100
UMK25	10	10	18	18	26	26	UMC22 + UAD100
UMK32	14	16	27.5	30	34	45	UMC32 + UAD100
UMK40	20	20	30	33.3	48	48	UMC40 + UAD100
UMK50	21	24	40	45	50	65	UMC50 + UAD100
UMK65	25	25	46	46	66	66	UMC65 + UAD100
UMK75	30	30	54	54	78	78	UMC75 + UAD100
UMK85	32	32	57	57	84	84	UMC85 + UAD100
UMK100	35	35	60	60	92	92	UMC100 + UAD100

Wiring Diagram

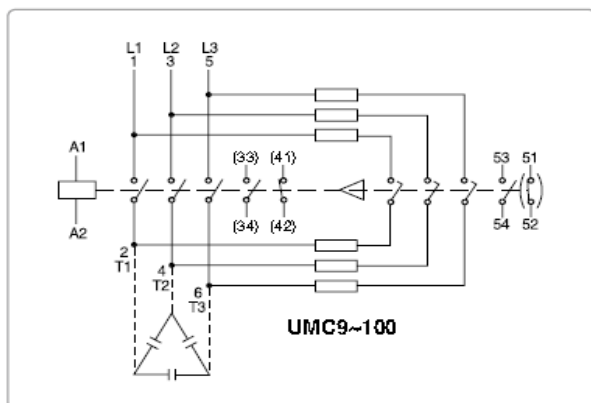

Contact no. 53, 54 is for the UAD100 10N (1NO).

Contact no. 51, 52 is for the UAD100 01N (1NC).

Features

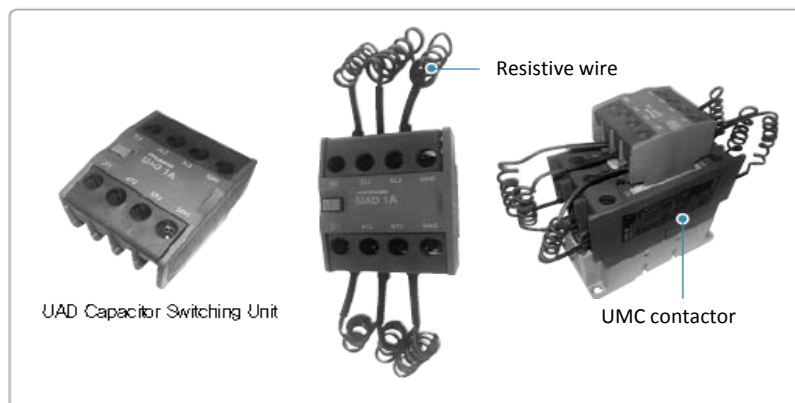

Dimensions

(Unit : mm)

UMK9, UMK12

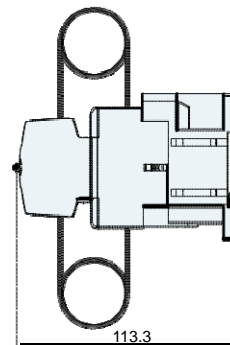
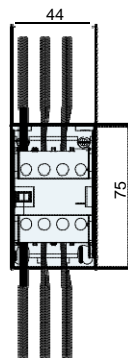

UMK18, UMK25, UMK32

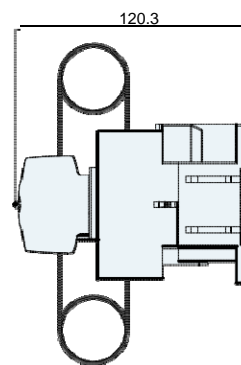
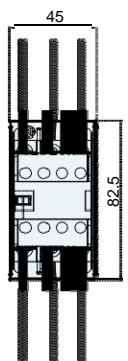

UMK40, UMK50, UMK65

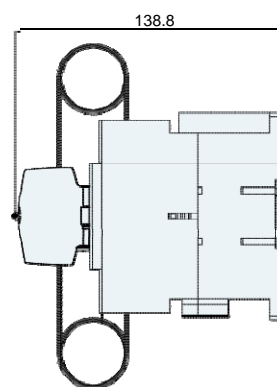
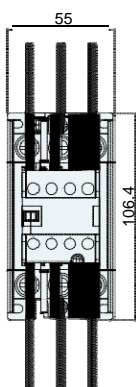

UMK75, UMK85, UMK100

